

GM-OCL Stainless Steel 316 Over Centre Latch

Features

- Heavy duty cast construction with strong holding power
- Designed to fit various applications for a tight seal on any compartment lid
- Off-center strike can be rotated to achieve desired catch tension
- Stainless steel mechanism presents smooth, low profile appearance in the closed position
- **GM-OCL-A507878**: Complete with eye for padlock up to 6 mm shackle

Material

- Stainless steel 316

Parts Included

- Except for **GM-OCL-J907882/4**, rest of models come included with J907881-G (strike installation jig) for easy installation



W/ Eye



Standard



90° Mount

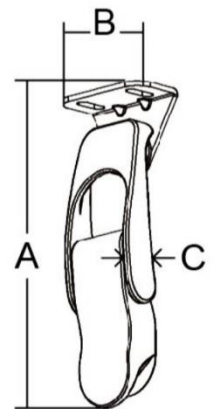
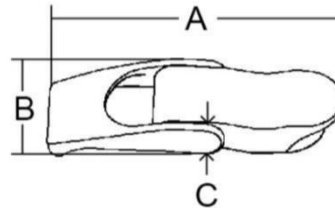
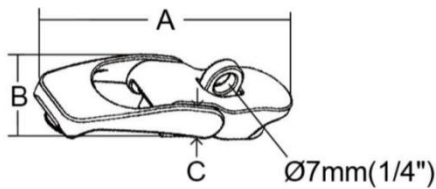

Part No.	Type	Lock	A	B	C	Latch Base	Strike
GM-OCL-A507878	With Eye	No	82.5	25	15	#8 or M4	#8 or M4
GM-OCL-J907881	Standard	Yes	82				
GM-OCL-J907883		No	105	30	19	1/4" or #10 or M5	
GM-OCL-J907981		Yes					
GM-OCL-J907983		90° Mount	No	91	32	15	#8 or M5
GM-OCL-J907882	Yes						
GM-OCL-J907884							